



Arranged in order the top & bottom components on the caliper. (as shown in FIG.1)

Fixed the complete caliper set on the front fork or frame, then remove the ★ away. (as shown in FIG.2)

Tighten the screws to complete the installation.

### Parts demand for PM7

1.Long screw	X1	2.Concave washer	X2	3.Convex washer	X4	4.Concave washer(TOP)	X1
5.Short screw	X1	6.Concave washer	X1				

### Parts demand for PM8

1.Long screw	X1	2.Concave washer	X2	3.Convex washer	X4	4.Concave washer(TOP)	X1
5.Short screw	X1	6.Concave washer	X1	7.Flat washer	X4		

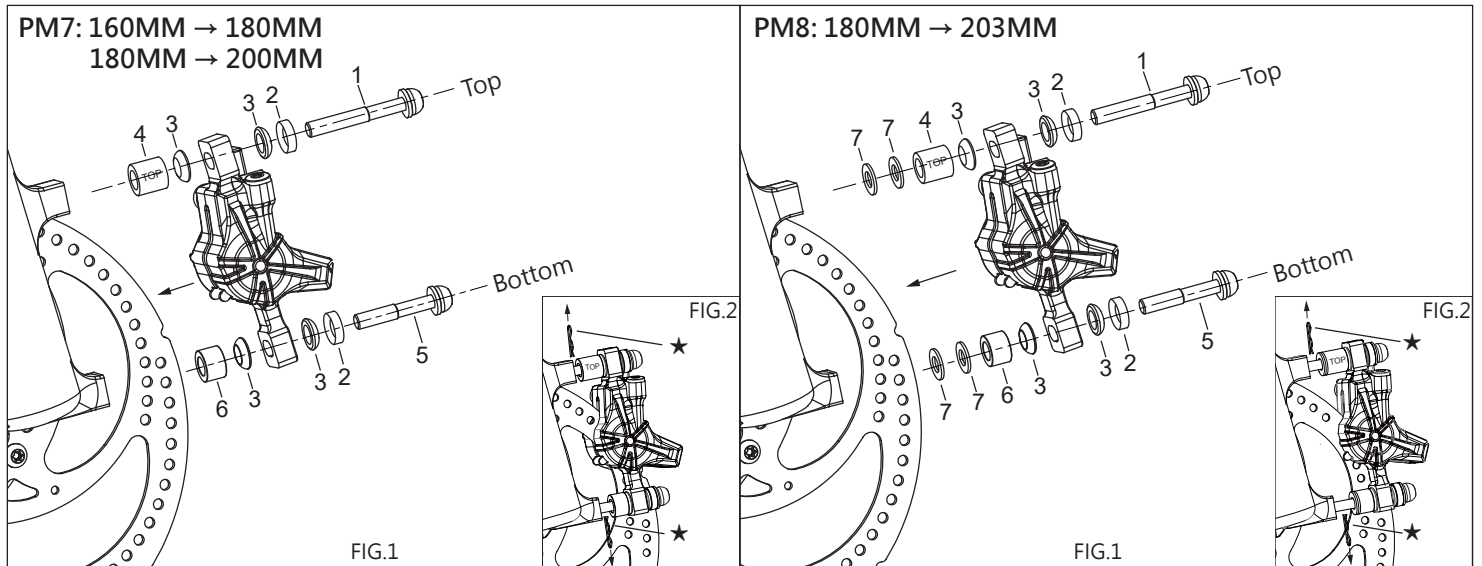

步驟一:依FIG.1順序將上組件 & 下組件組合於卡鉗上。

步驟二:將已組合套件之卡鉗固定於前叉或車架上並移除★附件(FIG.2), 鎖附螺絲(長)&螺絲(短)依標準組裝程序即可完成組裝。

### PM7 零件表

1.螺絲(長)	X1	2.凹華司(薄)	X2	3.凸華司	X4	4.凹華司(TOP)	X1
5.螺絲(短)	X1	6.凹華司(中)	X1				

### PM8 零件表

1.螺絲(長)	X1	2.凹華司(薄)	X2	3.凸華司	X4	4.凹華司(TOP)	X1
5.螺絲(短)	X1	6.凹華司(中)	X1	7.平華司	X4		

