

# BENGAL Distributor information

## Brazil Distributor

J.T.COM IMP E EXP LTDA  
TEL/FAX:+55-11-5678-2694  
Website: www.joytech.com.br  
Contact: joytech@joytech.com.br

## China General Distributor

YIH JENG SING BICYCLE COMPONENTS (C.Z.) CO., LTD  
No.37, Aoyuan Road, Xinbei District, Changzhou,  
Jiangsu, 213001, China  
TEL/FAX: +86 0519-83532079  
Contact: robert6402@kimo.com

## China Distributor

BAINA SANFENG VEHICLE INDUSTRY CO.,LTD.  
No. 89, Xiaolin East Road, Kunshan City,  
Jiangsu Province,China  
TEL: +86 159-50922601 FAX: +86 0512-36862651  
Contact: sanfengcheye@163.com

## Spain & Andorra Distributor

RACING CYCLE  
Rua dos Lagoeiros armz 54 2415 -645 Leiria Portugal  
Tel:+351 244 027 584 / +351 244 043 616  
Contact: info@racingcycle.net

## Taiwan Distributor

HARVEST YEAR TECHNOLOGY COMPANY  
No.70-3, Zhonglu rd., Xiushui Township,  
Changhua County 504, Taiwan  
TEL: +886-4-7691929 FAX: +886-4-7691858  
Contact: hy.bike88@msa.hinet.net

## Portugal Distributor

RACING CYCLE  
Rua dos Lagoeiros armz 54 2415 -645 Leiria Portugal  
Tel:+351 244 027 584 / +351 244 043 616  
Contact: info@racingcycle.net



# **BENGAL**

## DISC BRAKE



The latest distributor information will be updated, please refer to our website



Bengal Performance Brake Systems  
sales@bengalperformance.com.tw  
www.bengalperformance.com.tw

# Hydraulic Disc Brake | ARES 8.5



## Technical specifications

- Side push open hydraulic disc brake system
- Aluminum forged master cylinder and caliper
- Master cylinder with reach adjustment
- 2-Piece clamp for easy assembly
- Window for driver easily inspect if pads have worn, clean and mud out
- One master cylinder with dual caliper
- Application: TRICYCLE, E-BIKE, SPECIAL TYPE



## ▪ Weight

Master cylinder: 126g

Caliper: 112g

## ▪ Lever

4-finger ball-end lever blade

## ▪ Rotor

1.8mm thickness(C)

## ▪ Pad

Semi-metallic compound

## ▪ Optional

L: Parking Lock

T: 2.3mm thickness

EZ: EZ PLUG IN

E: Power cut-off sensor for E-bike (Connector types please refer P.04)

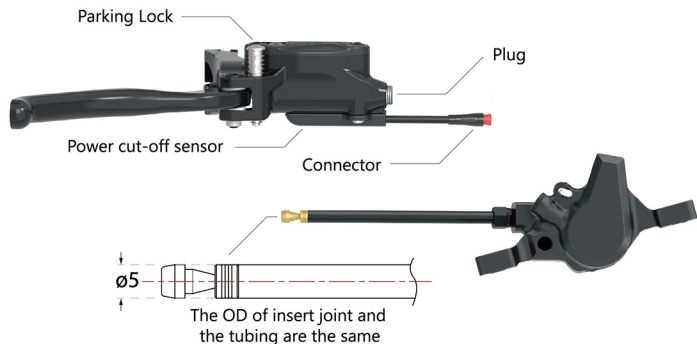

## EZ PLUG IN (Optional) internal cable routing

Setp.1



Thread through the frame

Setp.2



Remove the nut

Setp.3



Remove the plug

Setp.4



Fasten the hose kit

PATENT NO : M518750/ZL201520796991.9

# Hydraulic Disc Brake | ARES 8/8+



## Technical specifications

- Side push open hydraulic disc brake system
- Aluminum forged master cylinder and caliper
- Master cylinder with reach adjustment
- 2-Piece clamp for easy assembly
- Window for driver easily inspect if pads have worn, clean and mud out
- Application: E-BIKE, SPECIAL TYPE, URBAN BIKE



- **Weight**  
Master cylinder: 129g  
Caliper: 112g
- **Lever**  
4-finger ball-end lever blade
- **Rotor**  
1.8mm thickness(C)
- **Pad**  
Semi-metallic compound
- **Optional**  
L: Parking Lock  
T: 2.3mm thickness  
+: Hose length ≥1600mm  
EZ: EZ PLUG IN  
E: Power cut-off sensor for E-bike

## Notice magnetic field

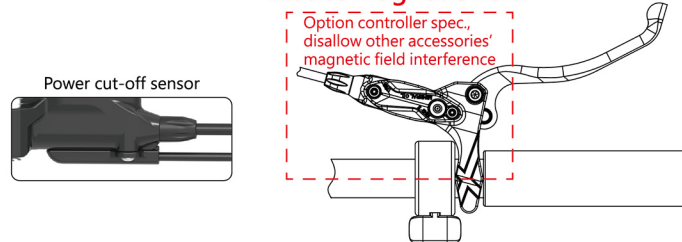

## Connector types





## Hydraulic Disc Brake | ARES 7.5



### Technical specifications

- Direct push open hydraulic disc brake system
- Aluminum forged master cylinder and caliper
- Master cylinder with reach adjustment
- Patented "EZ-out" brake pad replacement
- Window for driver easily inspect if pads have worn, clean and mud out
- One master cylinder with dual caliper
- Application: TRICYCLE, E-BIKE, SPECIAL TYPE

### Weight

Master cylinder: 100g  
Caliper: 120g

### Lever

4-finger ball-end lever blade

### Rotor

1.8mm thickness(C)

### Pad

Semi-metallic compound

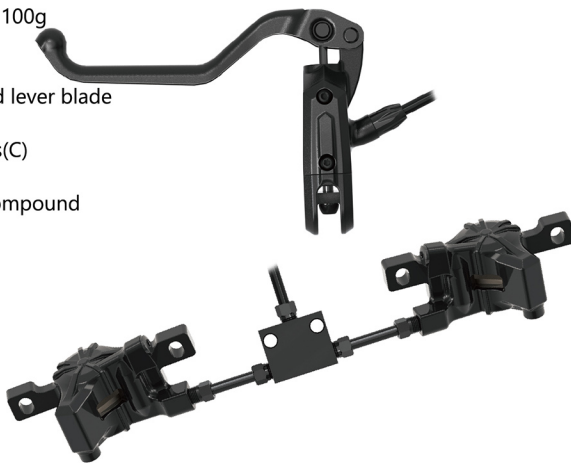

### Optional

L: Parking Lock  
b: Bell  
EZ: EZ PLUG IN

E: Power cut-off sensor for E-bike (Connector types please refer P.04)

## Hydraulic Disc Brake | ARES 7+

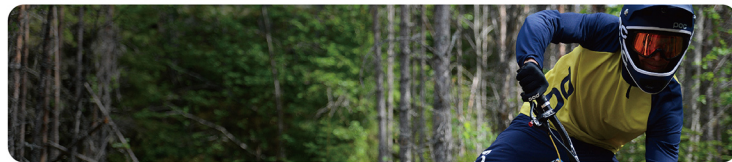

### Technical specifications

- Direct push open hydraulic disc brake system
- Aluminum forged master cylinder and caliper
- Master cylinder with reach adjustment
- Patented "EZ-out" brake pad replacement
- Window for driver easily inspect if pads have worn, clean and mud out
- Application: E-BIKE, SPECIAL TYPE, URBAN BIKE

### Weight

Master cylinder: 100g  
Caliper: 120g

### Lever

4-finger ball-end lever blade

### Rotor

1.8mm thickness(C)

### Pad

Semi-metallic compound

Power cut-off sensor



Bell



Parking Lock



### Optional

L: Parking Lock  
b: Bell  
EZ: EZ PLUG IN

E: Power cut-off sensor for E-bike (Connector types please refer P.04)



# Hydraulic Disc Brake | ARES 4E



## Technical specifications

- Side push open hydraulic disc brake system
- Aluminum forged master cylinder and caliper
- 4 piston caliper with thickening rotor and brake pads
- Master cylinder with reach adjustment
- "EZ-adjust" hose connector for frame
- 2-Piece clamp for easy assembly
- Window for driver easily inspect if pads have worn, clean and mud out
- Application: E-BIKE, URBAN BIKE

Adjustable up to 180 degrees



Two-piece clamp

## ▪ Weight

Master cylinder: 129g

Caliper: 159g

## ▪ Lever

4-finger ball-end lever blade

## ▪ Rotor

2.3mm thickness(T)

## ▪ Pad

Semi-metallic compound (5mm)

## ▪ Optional

L: Parking Lock

EZ: EZ PLUG IN

E: Power cut-off sensor for E-bike (Connector types please refer P.04)

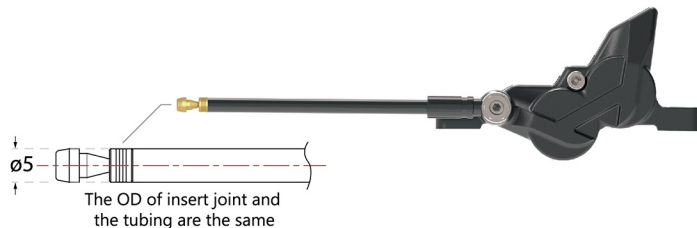
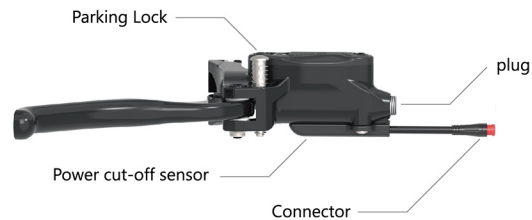

## Hydraulic Disc Brake | ARES 4



### Technical specifications

- Side push open hydraulic disc brake system
- Aluminum forged master cylinder and caliper
- 4 piston caliper design
- Master cylinder with reach adjustment
- 2-Piece clamp for easy assembly
- "EZ-adjust" hose connector for frame
- Window for driver easily inspect if pads have worn, clean and mud out
- Application: E-BIKE, URBAN BIKE

### Weight

Master cylinder: 129g

Caliper: 161g

### Lever

4-finger ball-end lever blade

### Rotor

1.8mm thickness(C) Adjustable up to 180 degrees

### Pad

Semi-metallic compound

### Optional

L: Parking Lock

T: 2.3mm thickness

EZ: EZ PLUG IN

E: Power cut-off sensor for E-bike (Connector types please refer P.04)



## Hydraulic Disc Brake | ARES 4M



### Technical specifications

- Side push open hydraulic disc brake system
- Aluminum forged master cylinder and caliper
- 4 piston caliper design
- Master cylinder with reach adjustment
- 2-Piece clamp for easy assembly
- "EZ-adjust" hose connector for frame
- Window for driver easily inspect if pads have worn, clean and mud out
- Application: MTB

### Weight

Master cylinder: 126g

Caliper: 161g

### Lever

2-finger ball-end lever blade

### Rotor

1.8mm thickness(C) Adjustable up to 180 degrees

### Pad

Semi-metallic compound

### Optional

T: 2.3mm thickness

EZ: EZ PLUG IN



# Hydraulic Disc Brake | ARES 5



## Technical specifications

- Side push open hydraulic disc brake system
- Aluminum forged master cylinder and caliper
- Master cylinder with reach adjustment
- "EZ-adjust" hose connector for frame
- 2-Piece clamp for easy assembly
- Window for driver easily inspect if pads have worn, clean and mud out
- Application: XC, TRAIL, AM, FR, DH

Adjustable up to 180 degrees



- **Weight**  
Master cylinder: 90g  
Caliper: 120g
- **Lever**  
1.5-finger blade
- **Rotor**  
1.8mm thickness(C)
- **Pad**  
Semi-metallic compound

- **Optional**  
Tool free reach adjustment  
EZ: EZ PLUG IN

Tool free reach adjustment

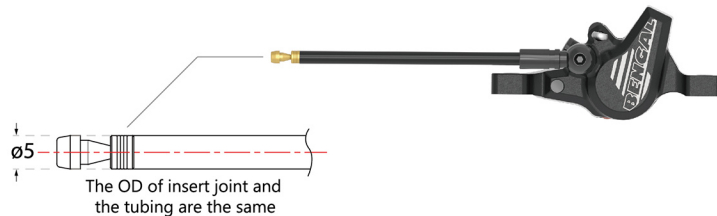



## Hydraulic Disc Brake | ARES 3



### Technical specifications

- Side push open hydraulic disc brake system
- Aluminum forged master cylinder and caliper
- Master cylinder with reach adjustment
- Patented "EZ-out" brake pad replacement
- Window for driver easily inspect if pads have worn, clean and mud out
- Application: XC, TRAIL, AM

### Weight

Master cylinder: 102g  
Caliper: 120g

### Lever

2-finger blade

### Rotor

1.8mm thickness(C)

### Pad

Semi-metallic compound



### Optional

b: Bell  
EZ: EZ PLUG IN  
E: Power cut-off sensor for E-bike (Connector types please refer P.04)

## Hydraulic Disc Brake | ARES 3B

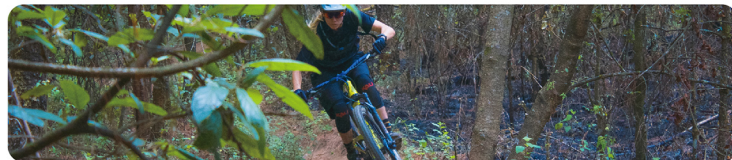

### Technical specifications

- Side push open hydraulic disc brake system
- Aluminum forged master cylinder and caliper
- Master cylinder with reach adjustment
- Patented "EZ-out" brake pad replacement
- Window for driver easily inspect if pads have worn, clean and mud out
- Application: E-BIKE, URBAN BIKE

### Weight

Master cylinder: 105g  
Caliper: 120g

### Lever

3-finger ball-end lever blade

### Rotor

1.8mm thickness(C)

### Pad

Semi-metallic compound



### Optional

b: Bell  
EZ: EZ PLUG IN  
E: Power cut-off sensor for E-bike (Connector types please refer P.04)

# Mechanical Disc Brake

- Single piston activation for peak stopping power "PSP"
- Non-binding-groove-proline-cable routing that keeps the cable in-direct pull between the anchor bolt and the cable housing
- Window for driver easily inspect if pads have worn, clean and mud out

## MB 700

### Technical specifications

- Compact, light weight, 1-piece aluminum forged caliper design
- Application: MTB, URBAN

Weight: 166g

Rotor: 1.8mm thickness(C)

Pad: Semi-metallic compound



## MB 500A

### Technical specifications

- 2-piece aluminum die casting design
- Application: MTB, URBAN, TRICYCLE, PEDICAB, E-BIKE

Weight: 214g

Rotor: 1.8mm thickness(C)

Pad: Semi-metallic compound



## MB 700T

### Technical specifications

- Compact, light weight, 1-piece aluminum forged caliper design
- Application: Road bike, Touring bike, Cyclocross bike and STI lever bike

Weight: 166g

Rotor: 1.8mm thickness(L)

Pad: Semi-metallic compound



## MB 500B

### Technical specifications

- Special design for the right side mount
- 2-piece aluminum die casting design
- Application: MTB, URBAN, TRICYCLE, PEDICAB, E-BIKE

Weight: 214g

Rotor: 1.8mm thickness(C)

Pad: Semi-metallic compound



## MB 600

### Technical specifications

- 2-piece aluminum die casting design
- Application: MTB, URBAN

Weight: 208g

Rotor: 1.8mm thickness(C)

Pad: Semi-metallic compound



## MB 500

### Technical specifications

- 2-piece aluminum die casting design
- Application: MTB, URBAN

Weight: 212g

Rotor: 1.8mm thickness(C)

Pad: Semi-metallic compound



# ROTORS

		6 (C)	12 (L)	6 (T)
Rotor OD	Size	Weight	Weight	Weight
120mm	4"	90g	66g	-
140mm	5"	102g	86g	-
160mm	6"	136g	104g	-
180mm	7"	173g	134g	218g
203mm	8"	225g	172g	288g
220mm	9"	-	-	332g
Note				2.3mm thickness w/ exclusive calipers

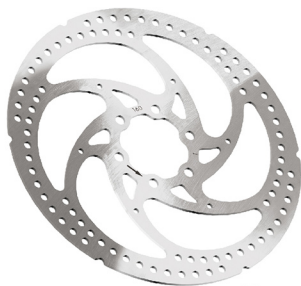

Wave 6



Wave 12



BR 301 Center lock adaptor  
Fit to under 10mm thru axle



BR 303 Center lock adaptor

# ADAPTORS

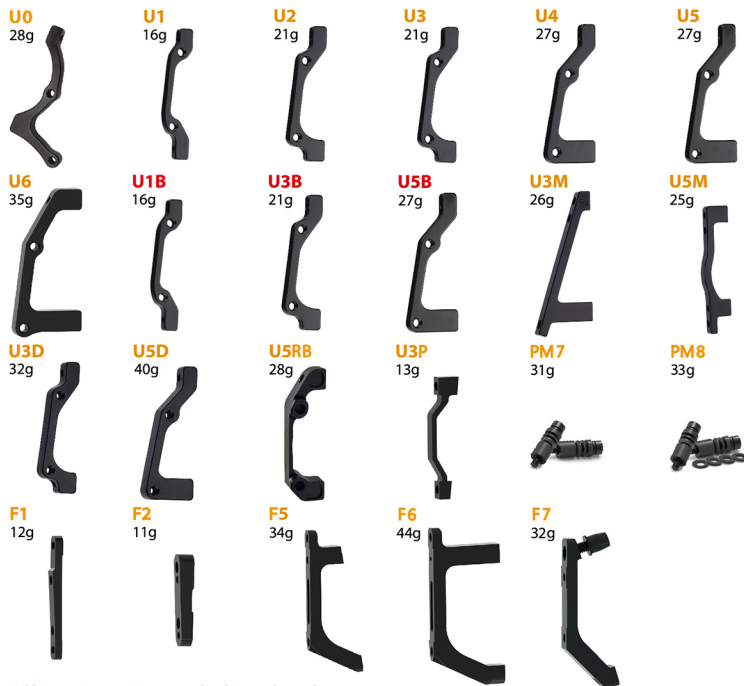

## All series Bengal disc brake

Fork / R		IS-51		PM-74		IS-51 (20mm)		IS-51 (mirror)		FM-70	FM-34	FM-70	FM-34
	Caliper	post mount		post mount		post mount		flat mount		post mount			
	rotor OD	front	rear	front	rear	front	front/rear	front	rear	front	rear	front	rear
5"	140									F1	DM	F5	F7
	160									F1	F2	F6	
	140	U0	U1										
6"	160	U1	U2	DM	DM			U1B					
	180	U3	U4	U3M/U3P/PM7	U3M/U3P/PM7			U3D	U3B				
	203	U5	U6	U5M	U5M	U5D	U5B						
	180			DM	DM								
7"	200			U3M/U3P/PM7	U3M/U3P/PM7								
	203			PM8	PM8								

DM=Direct Mount

U5RB / Rockshox Boxxer IS mount