

## Mechanical Disc Brake Assembly Instruction

### I. Mounting The Rotor to The Hub

- a. Rotor Fixing Bolt: Place the rotor on the mounting surface of the hub, and make sure the arrow on the rotor is pointing in the same direction of rotation in which the wheel moves forwards. Fasten M5 rotor fixing bolts with Torx T25 wrench in sequence with tightening torque at 6-8 Nm. (Fig.1)
- b. Center lock: Place the rotor on the mounting surface of the hub and fasten lock ring by socket with tightening torque at 35-40Nm.(310-354 in. lbs) (Fig.1)

### II. Mounting The Brake to The Frame or Front fork

1. Mount the brake to the frame or front fork using M6 adaptor fixing bolts with tightening torque at 8-10 Nm (71~89 in. lbs). Loosen the M6 caliper fixing bolts so that the position of the caliper can be micro adjusted (Fig.2). Note: Bengal disc brake is compatible with all forks and frames that conform to the international standard (51mm). It is also compatible with Manitou fork Post-mount (74mm) by dismounting the adaptor.
2. Install the cable wire through its adjuster, cable fixed screw and washer. Pull the cable tightly and fasten cable fixed screw to make wire fixed with the arm with torque at 6-8 Nm. (Fig.3)
3. Loosen the M4 hex screw with 2mm Allen driver. Using a 5mm Allen driver turn the pad adjuster clockwise until the pad touches the rotor, and then turn the pad adjuster counter clockwise 1/3 of a turn. Squeeze and hold the brake lever making the pads clamp the rotor tightly. While holding the lever, torque the caliper fixing bolts at 8-10 Nm and then release the brake lever. Turn the pad adjuster counter clockwise 1/3 of a turn. Tighten the M4 hex screw at 1-3 Nm of torque. Finally, spin the wheel. If there is noise or drag, should re-loosen the caliper fixing bolts and adjust the position of caliper again, if it can spin freely, the installment is completed.

### III. Maintenance

1. When the braking power is weakened, it means the brake pads have worn down and should be adjusted back to their original braking condition. To adjust the brake pads should loosen the M4 hex screw. Turn the pad adjuster clockwise until the brake lever can be approximately parallel to the handlebar while the lever is squeezed and remains holding. Then tighten the M4 hex screw at at torque of 1-3 Nm to complete the adjustment.
2. But if the noise occurs while braking. It should be the time to replace the brake pads: Remove the wheel. Loosen the M4 hex screw and turn the pad adjuster counter clockwise until the brake pads can be removed. Remove the outer pad first, and then remove the inner pad. Install new inner pad first and then outer pad. (Fig.4) Finally, see "Mounting the Brake to the Frame or Front fork "above for proper set-up.

### IV. Notice!

1. Bengal disc brakes are designed for bicycle using!! To assemble on any other kinds of vehicles will not be warranted by Bengal. Improper installation could cause severe injuries.
2. A qualified technician with the proper tools should perform installation of the disc brake components.

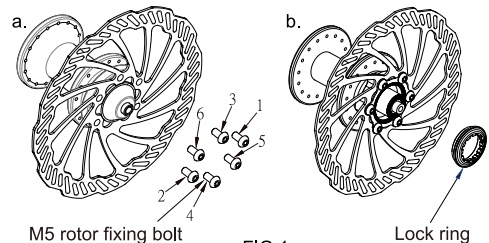

FIG.1

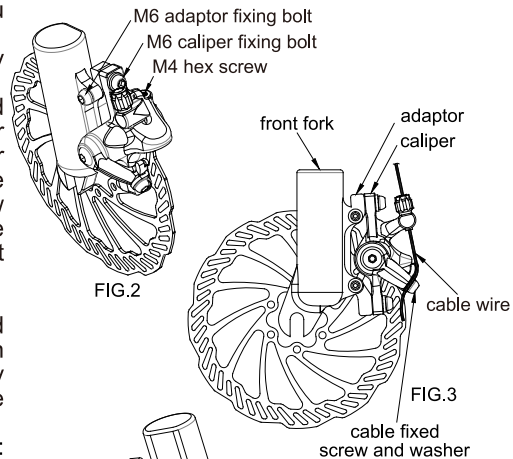

FIG.2

FIG.3

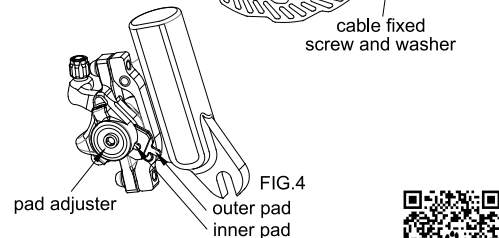

FIG.4

